

SANKIKEY

Bolted Two And Three Piece
FLOATING BALL VALVE



SANKEY

VALVE . ACTUATION . LSB

| CONTENTS |

Company Profile and Clients	1
Introduction & Manufacturing Range	2
Sankey Key Features & Benefits	3
Series 15 3D Sectional View	4
Series 15, 30, 60 Flanged End Ball Valves	5
Series 15/30 L&T Three Way Ball Valves	6
Series 15/30 J Jacketed Ball Valves	7
Series 40 & 40L Screwed End & Weld End Ball Valves	8
Series 70, 80 & 90 High Pressure Ball Valves	9
Series WF, 15C, & FTB	10
Metal Seated Ball Valve	11
Pressure/Temperature Charts & Applicable Standards	12
Automation & Actuation Capabilities	13

THE COMPANY

Reliability In Your Process.....

Combining almost 35 years of experience in critical application in chemicals, oil and gas, Sankey Controls Pvt. Ltd. (formerly known as Siddharth Engineers) has brought together a team of engineers with a long experience as part of design team. Advance Software application, Finite Element Analysis (FEA), Computational Flow Dynamics (CFD) and 3D solid modeling, help Sankey design superior quality valves that meet the most demanding performance requirement.

Sankey's QA system is geared towards continuous improvement, process quality and stringent compliance to worldwide quality standards. (Eg. ASME section III, PED, ISO).

Advanced tooling design and optimized industrial engineering, combined with our state of the art 10000 sq ft manufacturing plants with in-house CNC & VMC, enables us to provide high quality products at competitive cost to our valued customers.

Turnkey Projects & Services:-

We undertake complete projects, which involves supply of valves, pressure vessel, pumps & other hardware, piping instrumentation, PLC and control, data acquisition, installation and commissioning and also undertake servicing of all types of valves and automation.

We are an approved defense vendor and have completed prestigious projects such as

- Automation of Scramjet Combustor Test Facility
- Automation of Ramjet Combustor Test Facility

Services: Refurbish, Repair & Maintain

Sankey undertakes servicing of all types of valves and Automation, Annual Maintenance Contracts for valve automation and also provides installation and commissioning support. Complete maintenance from site decommissioning, disassembly, workshop repair, site assembly, commissioning, and start-up.

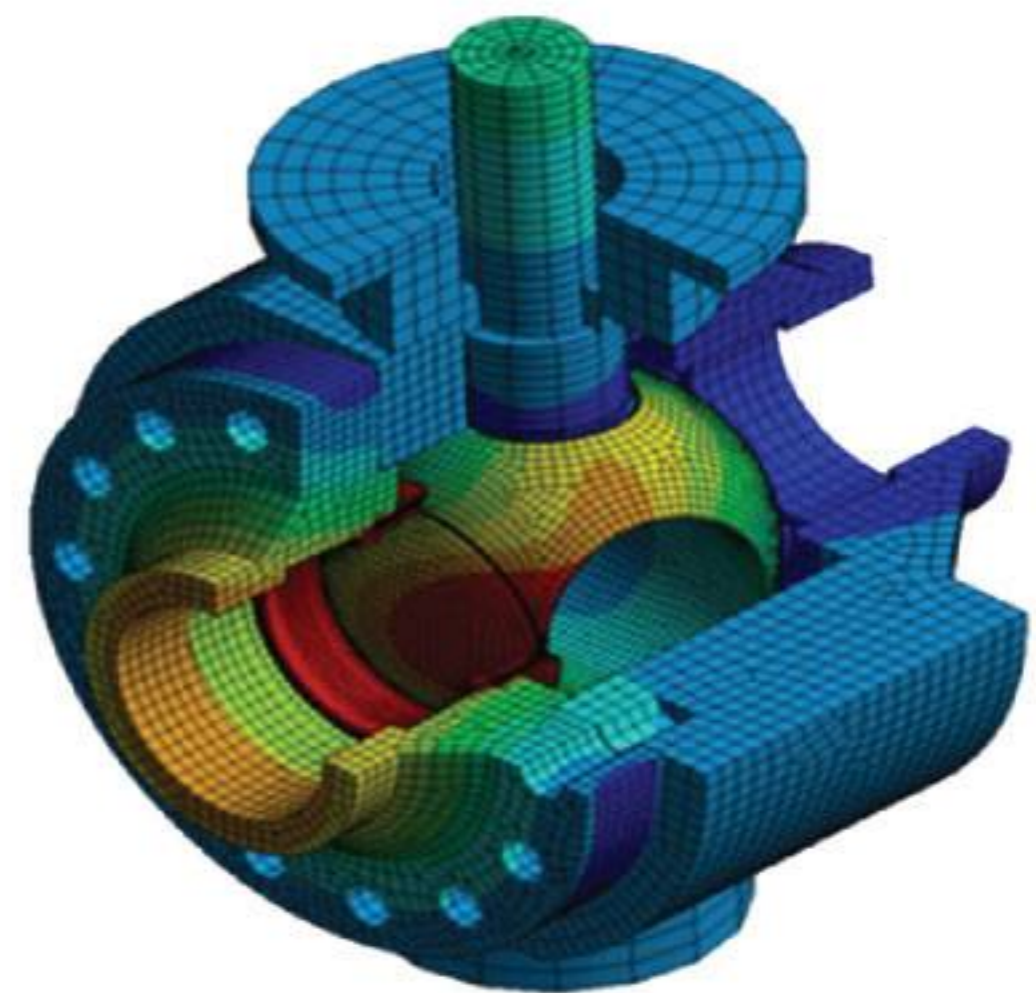

Technical Expertise, Quality and Service When And Where You Need It

Industrial Valves

Sankey is a leader in valve supply and has achieved exclusive, mass distributor status with manufacturing of recognized, high quality products. Sankey is ISO 9001:2000 certified and stocks an industry leading inventory of both commodity and specific application valves in a wide range of sizes, materials and pressure classes.

Sankey Extended Warranty

Sankey stands behind the products it sells and provides an industry leading warranty of 24 months from date of shipment or 18 months from the date of start-up (whichever is sooner) for all Sankey brand flanged or butt-weld floating ball valves.

Specific Application Valves

Sankey also stocks valves designed with specific

features and proper metallurgy to provide proven solutions for tough applications.

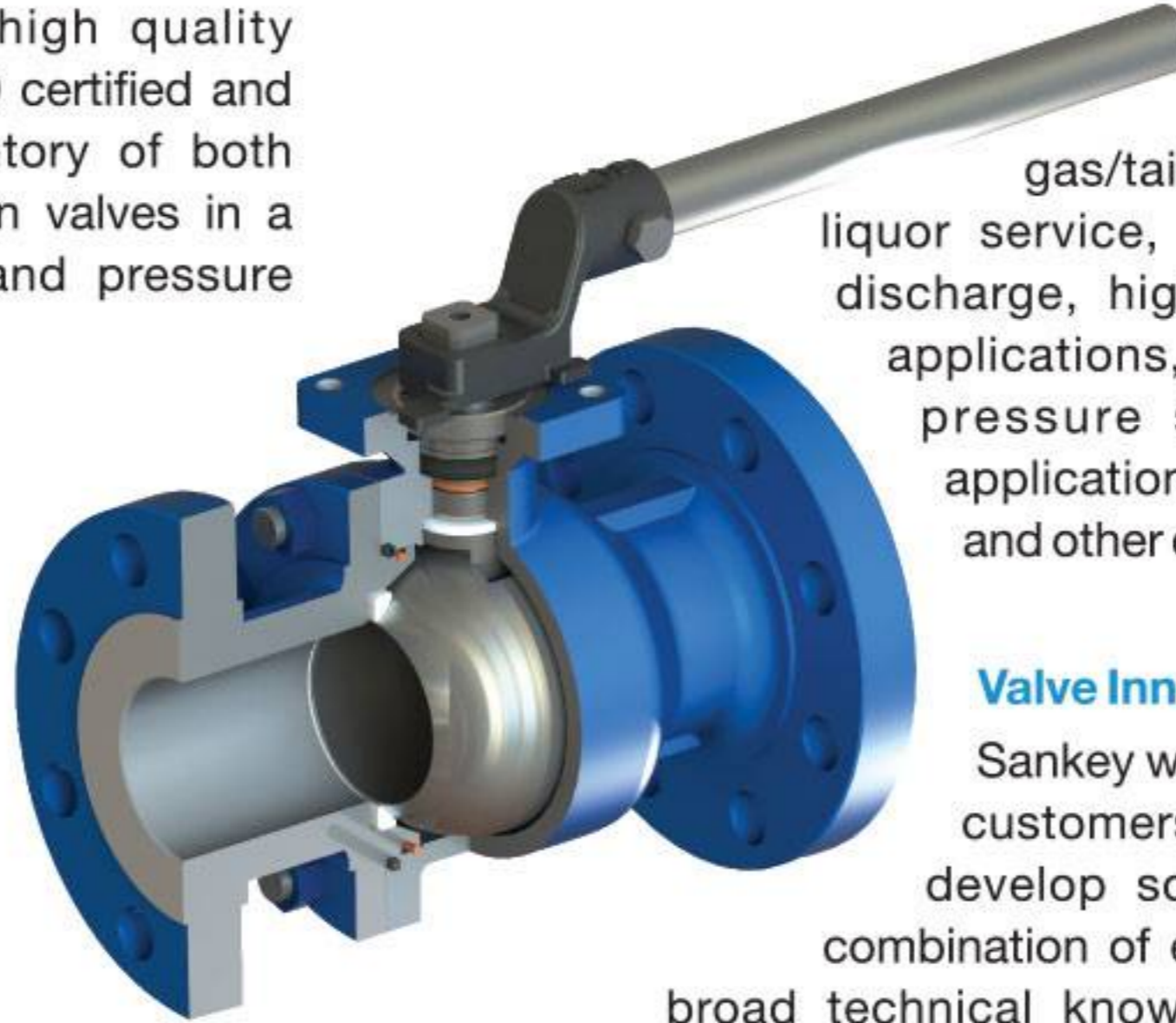

Applications include:

Molten sulphur, acid gas/tail gas service, pulp mill liquor service, pump and compressor discharge, high temperature/abrasive applications, pipeline pigging, high pressure steam and hot water applications, autoclave operations and other difficult services.

Valve Innovation

Sankey works in partnership with its customers and manufacturers to develop solutions to problems. A combination of experience resources and broad technical knowledge gives Sankey an advantage reflected in our product offering and strong customer relationships.

SANKEY FLOATING BALL VALVE

MANUFACTURING RANGE

(Available in full and regular port)

SIZE	ASME 150	ASME 300	ASME 600	ASME 900	ASME 1500	ASME 2500
1/2"	●	●	●	●	●	●
3/4"	●	●	●	●	●	●
1"	●	●	●	●	●	●
1 1/2"	●	●	●	●	●	●
2"	●	●	●	●	●	●
2 1/2"	●	●	●	●		
3"	●	●	●	●		
4"	●	●	●			
6"	●	●				
8"	●	●				
10"	●					

The Sankey series 15, 30 & 60 can handle a vast variety of fluids, semisolid and almost any corrosive service on chemical, oil, petrochemical, gas, pulp, paper processing and other industries. Our standard valves with CFT seats are suitable for steam.

General Features

- 2 piece bolted body design for ease of field service and maintenance
- Fire safe certified
- Standard valves meet NACE
- Extremely low torque for actuation savings
- ISO mounting pads, Direct mounting for actuators
- High life cycle
- Independent dual body seals
- Inert seals suitable for most service applications
- Locking device
- Body coated for corrosion protection



Certification & Testing

- API 608
- API 6D, design and dimensions
- API 6D high & low pressure seat tests (exceeds API 598 requirement)
- API 607 rev. 5 Fire Safe certificates
- ISO 9001
- Compliance with low emission standards
- Exceeds ANSI B16.34 wall thickness
- CE-PED
- NACE MR0175 & ISO 15156

Seat Design Features

- Unique high-volume Flexible Seat Rings
- Good shock resistance to high DP
- Compensation for pressure and temperature fluctuation
- Greater flexibility provides longer Life Cycle.

- Absolute seal in low and high pressure
- Latest modified PTFE in 600 class
- Self-relieving seats for automatic internal cavity relief

Stem Design Features

- Independent Stem rotation (Stem rotation is independent of gland nut)
- Anti-blowout (blowout proof) stem
- Double antistatic stem
- Three layer stem sealing arrangement for low emission control over long duration cycle
- Stem bearing/Guide is provide in gland nut prevents side load on seals and thus long life.
- Adjustable packing
- Additional stem O-ring
- Multi-independent stem packing seals

STATE OF THE ART FLOATING BALL VALVE

INERT SEALS FOR THE WIDEST RANGE OF SERVICE APPLICATIONS

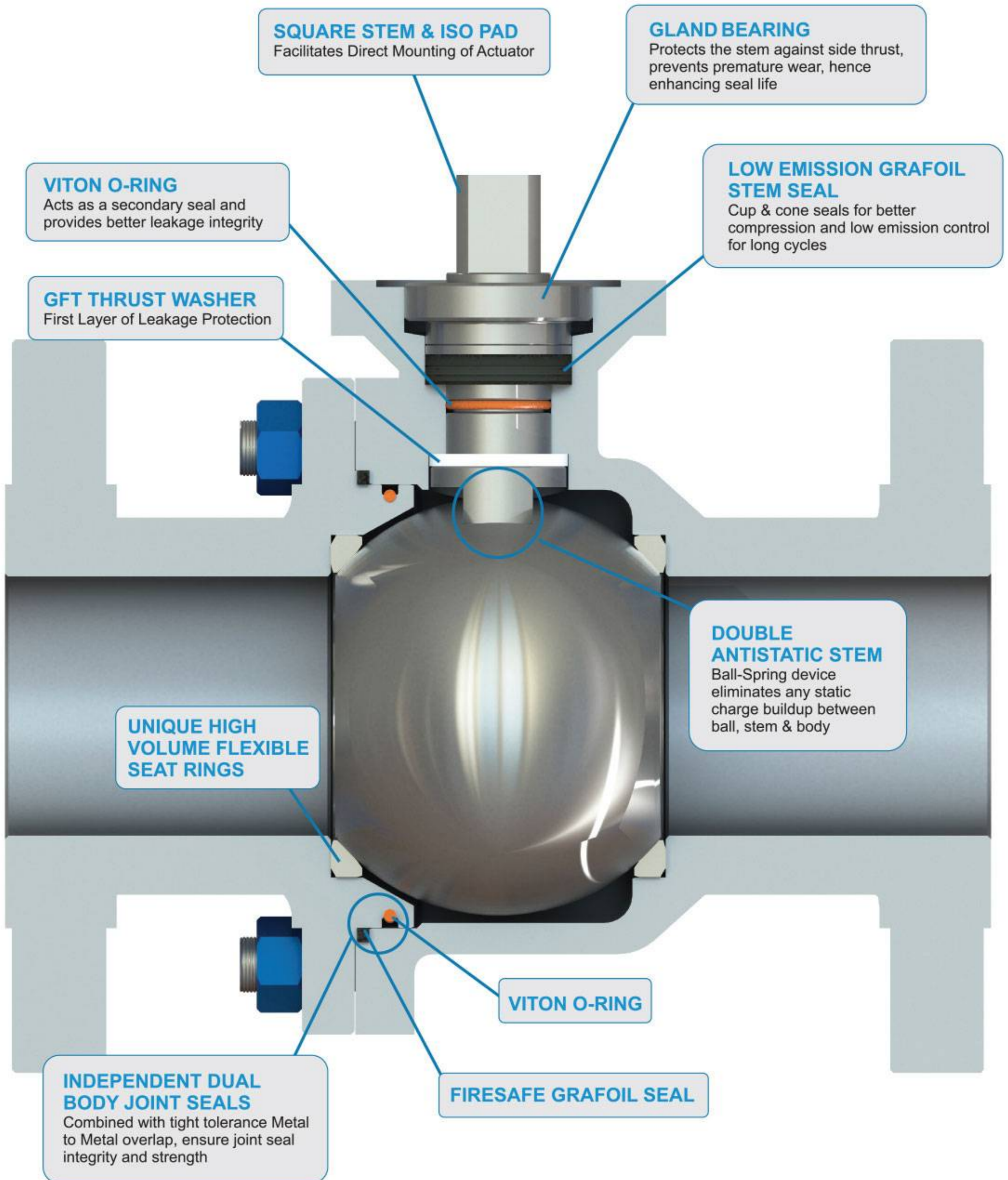

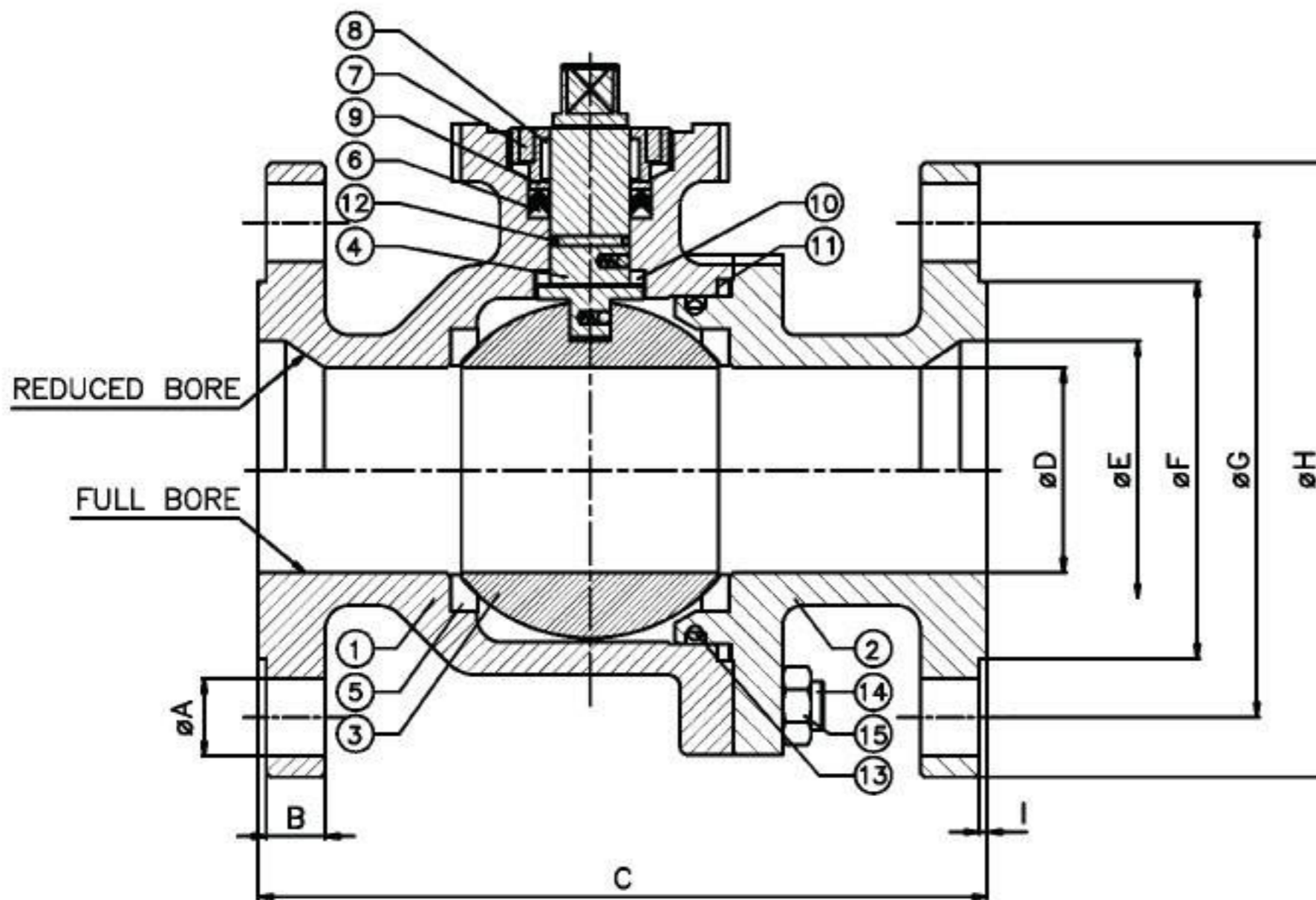

S.NO.	PART NAME
01	BODY
02	END CONN.
03	BALL
04	STEM
05	SEAT
06	STEM SEAL
07	GLAND
08	GLAND BEARING
09	SPACER
10	STEM THRUST WASHER
11	BODY SEAL
12	STEM O-RING
13	END-CONN. O-RING
14	STUD
15	HEX NUT

SIZE	15MM	20MM	25MM	40MM	50MM	65MM	80MM	100MM	150MM	200MM	250MM
	Only FB				#150 FB & RB						
ØA x Nos.	16x4	16x4	16x4	16x4	19x4	19x4	19x4	19x8	22x8	22x8	25.4x12
B	8	8.9	9.6	12.7	14.3	15.9	17.5	22.3	23.9	27	28.6
C	108	117	127	165	178	190	203	229	267(SP)	292(SP)	533
ØD(FB/RB)	13/NA	19/13	25/19	38/32	49/38	62/49	74/62	100/74	150/100	198/150	252/198
ØE(RB)	NA	19	25	38	49	62	74	100	150	198	252
ØF	35	43	51	73	92	105	127	157	216	270	324
ØG	60.3	69.9	79.4	98.4	120.7	139.7	152.4	190.5	241.3	298.5	362
ØH	90	100	110	125	150	180	190	230	280	345	405
I	2	2	2	2	2	2	2	2	2	2	2
Torque(Nm) (FB/RB)	5/NA	8/5	12/8	25/20	30/25	46/30	70/46	145/70	350/145	460/350	1200/800

SIZE	15MM	20MM	25MM	40MM	50MM	65MM	80MM	100MM	150MM	200MM	250MM	
	Only FB				#300 FB & RB							Only RB
ØA x Nos.	16x4	19x4	19x4	22x4	19x8	22x8	22x8	22x8	22x12	25x12	28.5x16	
B	12.7	14.3	15.9	19.1	20.7	23.9	27	30.2	35	39.7	46.1	
C	140	152	165	190	216	241	282	305	403	419(SP)	568	
ØD(FB/RB)	13/9	19/13	25/19	38/32	49/38	62/49	74/62	100/74	150/100	198/150	NA/198	
ØE(RB)	NA	19	25	38	49	62	74	100	150	198	252	
ØF	35	43	51	73	92	105	127	157	216	270	324	
ØG	66.7	82.6	88.9	114.3	127	149.2	168.3	200	270	330.2	387.4	
ØH	95	115	125	155	165	190	210	255	320	380	445	
I	2	2	2	2	2	2	2	2	2	2	2	
Torque(Nm) (FB/RB)	8/NA	9/8	16/9	30/25	35/30	55/35	100/55	160/100	480/160	900/480	NA/900	

SIZE	15MM	20MM	25MM	40MM	50MM	80MM	100MM	150MM
	Only FB				#600 FB & RB			Only RB
ØA	16x4	19x4	19x4	22x4	19x8	22x8	25.4x8	28.5x12
B	14.3	15.9	17.5	22.3	25.4	31.8	38.1	47.7
C	165	190	216	241	292	356	432	559
ØD(FB/RB)	13/NA	19/13	25/19	38/25	49/38	74/49	100/74	NA/100
ØE(RB)	NA	19	25	38	49	74	100	152
ØF	35	43	51	73	92	127	157	216
ØG	66.7	82.6	88.9	114.3	127	168.3	215.9	292
ØH	95	115	125	155	165	210	275	355
I	7	7	7	7	7	7	7	7
Torque(Nm) (FB/RB)	26/NA	30/26	66/30	100/66	134/100	304/134	500/304	500

Note: SP - Short Pattern

1. All dimensions are in mm unless otherwise specified.

2. As part of our commitment to continuous product development dimensions and specifications are subject to change without notice, for up to date information please contact us or visit our website.

SANKEY SERIES 15/30 L&T

#150 & #300 3 Way Flanged 'L' & 'T' Port Ball Valve

Sankey side entry three way ball valve offers diverting and mixing/selection flow patterns and often eliminates the need for two valves. The L-port configuration is available as a two piece design in two seat and T-port in four seat configuration thus is extremely versatile in various configurations and the full port design is easily automated as it comes in and is available with various seat materials for various pressure and temperature range.

General Features

- Two seat design for L-port and Four seat design for T-port maintains proper ball position.
- ISO 5211, direct mounting for actuation.
- Open and closed locking device for positional safety lockout.
- Flow plans for T & L ports can be field rearranged to meet many other flow plans.
- Body cavity fillers available.

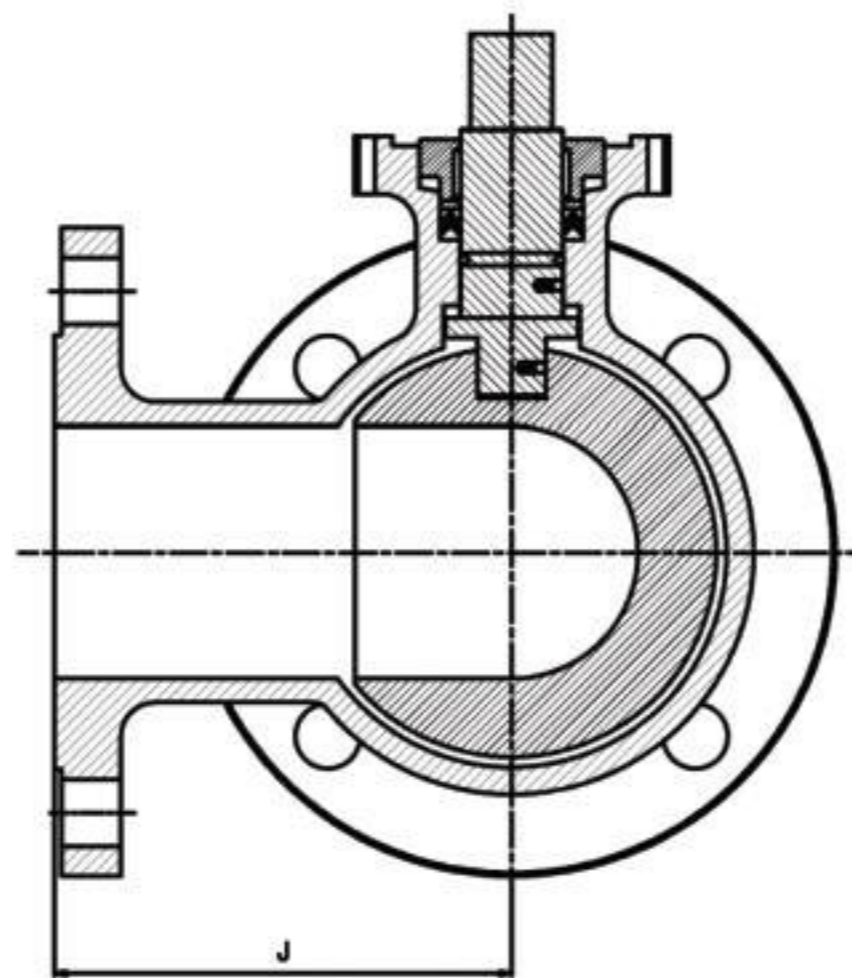
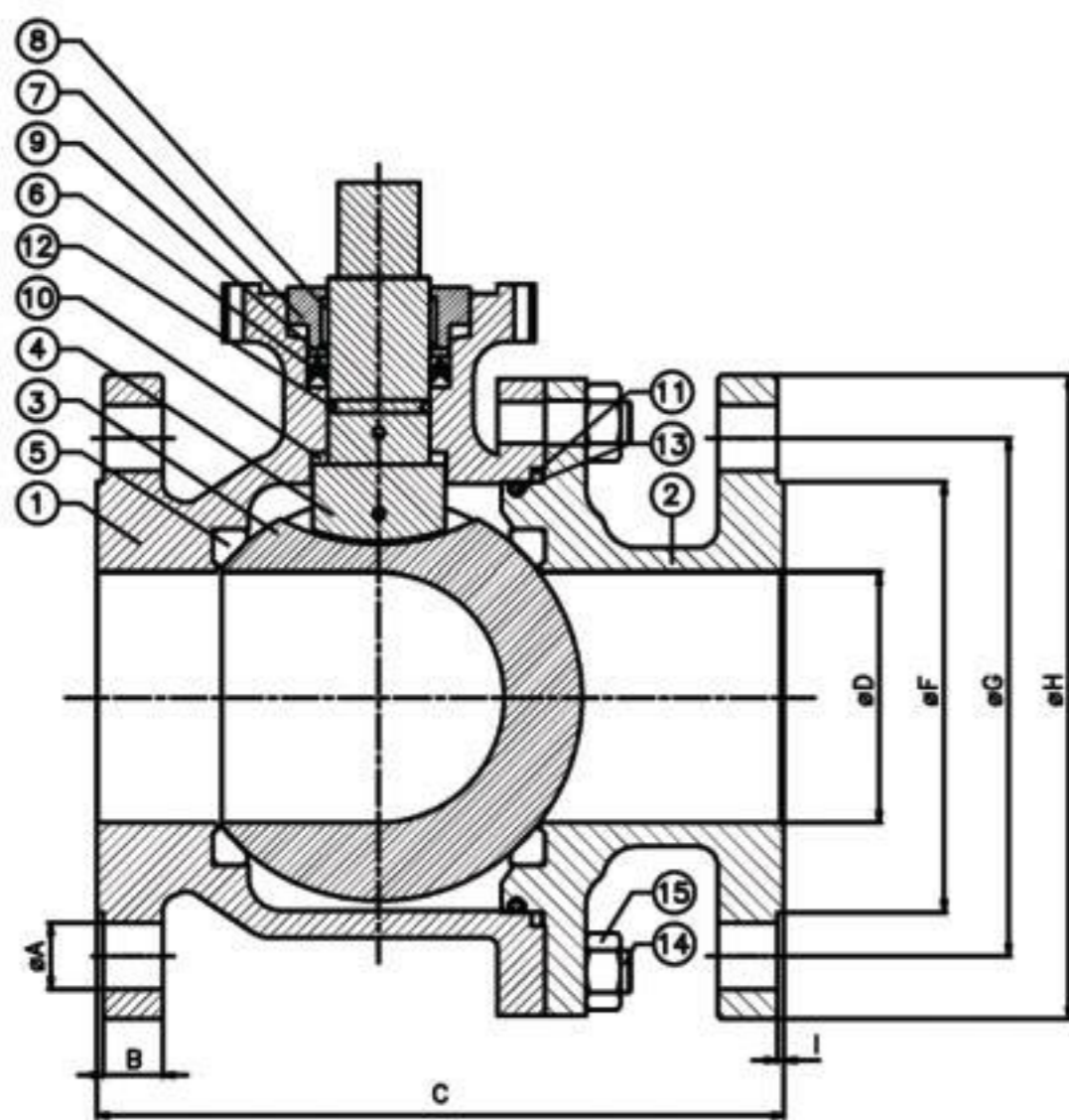

S.NO.	PART NAME
01	BODY
02	END CONN.
03	BALL
04	STEM
05	SEAT
06	STEM SEAL
07	GLAND
08	GLAND BEARING
09	SPACER
10	STEM THRUST WASHER
11	BODY SEAL
12	STEM O-RING
13	END-CONN. O-RING
14	STUD
15	HEX NUT

SIZE	15MM		20MM		25MM		40MM		50MM		80MM		100MM		150MM		200MM	
#150	#300	#150	#300	#150	#300	#150	#300	#150	#300	#150	#300	#150	#300	#150	#300	#150	#150	
ØA x Nos.	16x4	16x4	16x4	19x4	16x4	19x4	16x4	22x4	19x4	19x8	19x4	22x8	19x8	22x8	22x8	22x8	22x8	
B	8	12.7	8.9	14.3	9.6	15.9	12.7	19.1	14.3	20.7	17.5	27	22.3	30.2	23.9	27	27	
C	108	140	117	152	127	165	165	190	178	216	203	282	229	305	394	457	457	
ØD	13	13	19	19	25	25	38	38	49	49	74	74	100	100	150	198	198	
ØF	35	35	43	43	51	51	73	73	92	92	127	127	157	157	216	270	270	
ØG	60.3	66.7	69.9	82.6	79.4	88.9	98.4	114.3	120.7	127	152.4	168.3	190.5	200	241.3	298.5	298.5	
H	90	95	100	115	110	125	125	155	150	165	190	210	230	255	280	345	345	
I	2	2	2	2	2	2	2	2	2	2	2	2	2	2	2	2	2	
J	70	80	75	85	80	95	99	120	108	130	134	165	170	200	215	260	260	
Torque(Nm)	5	8	8	9	12	16	25	30	30	35	70	100	140	160	350	460	460	

L-Port Configuration

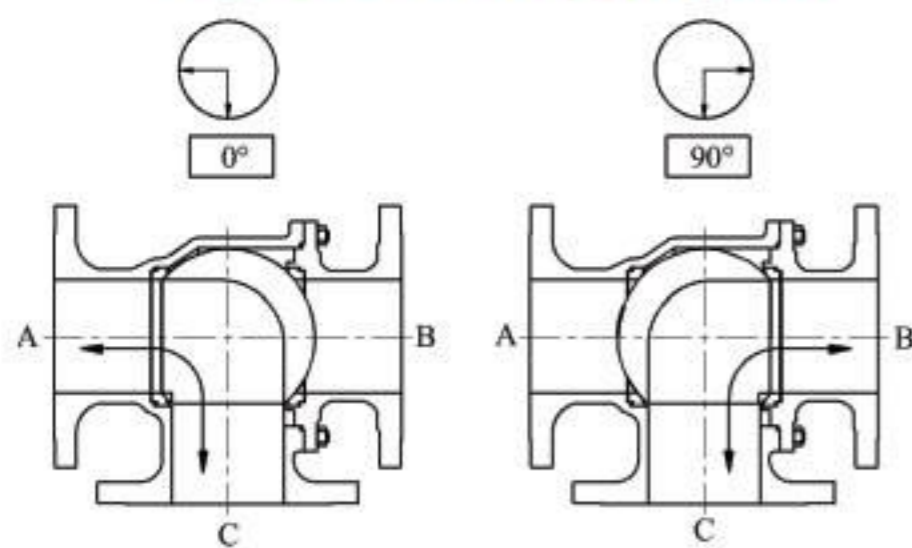

T-Port Configuration

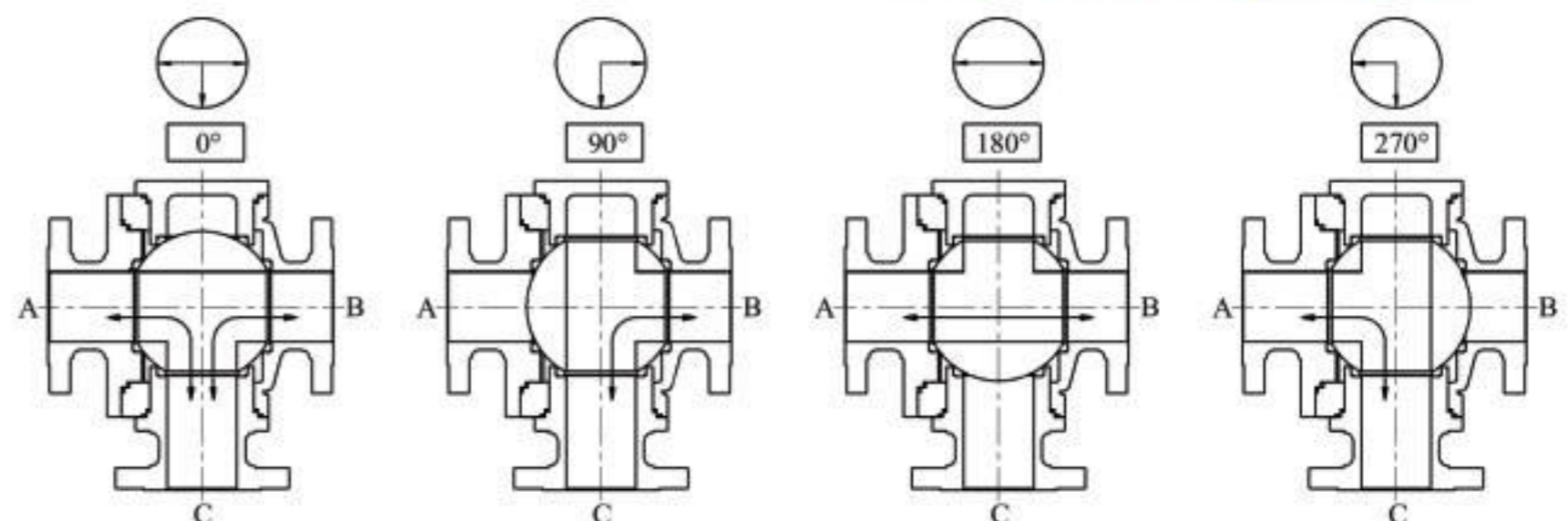

SANKEY SERIES 15/30 J

#150, #300 Full Jacketed Ball Valve

Jacketed ball valves to handle highly viscous materials or materials that solidify at ambient temperatures are available for use with steam or other heat transfer media.

Sankey Full Jacketed Ball valves are designed in Single-Piece Welded Jacket construction for Standard Bore valves. The jacket extends from one flange to other which is generally oversize with face to face dimension of corresponding valve. The jacket comes in two piece construction welded together. The jackets of the valves can be rated for heat transfer media pressure up to 22 bars, In Standard design the jacket is rated at 10.3 bars. The valve can also be used in FDA / Sanitary Applications.



General Features

- Full Compliance to API-6D & BS EN ISO 17292
- Fire Tested to API-607.
- Available with Cavity Filler design
- Available in Metal seated design for high temperature application

S.NO.	PART NAME
01	BODY
02	INSERT
03	BALL
04	STEM
05	SEAT
06	STEM SEAL
07	GLAND
08	GLAND BEARING
09	SPACER
10	STEM THRUST WASHER
11	BODY SEAL
12	STEM O-RING
13	INSERT O-RING
14	CAVITY
15	JACKET

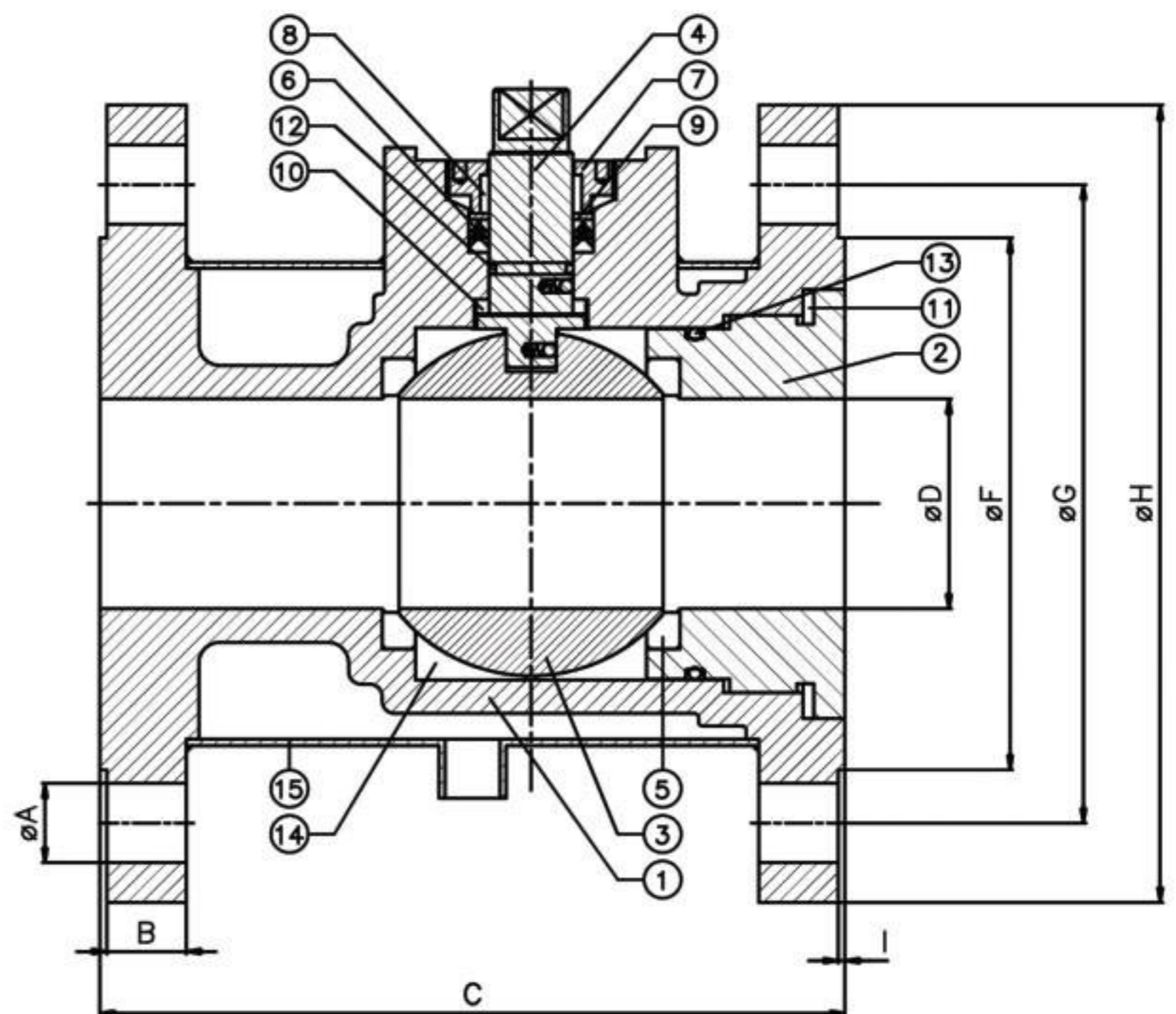

SIZE	15 X 25		25 X 50		40 X 65		50 X 80		80 X 100		100 X 150		150 X 200		150 X 250		200 X 300	
	#150	#300	#150	#300	#150	#300	#150	#300	#150	#300	#150	#300	#150	#150	#300	#150	#300	
ØA x Nos.	16x4	19x4	19x4	19x8	19x4	22x8	19x4	22x8	19x8	22x8	22x8	22x12	22x8	25.4x12	28.5x16	25.4x12	32x16	
B	9.6	15.9	14.3	20.7	15.9	23.4	17.5	27	22.3	30.2	23.9	35	27	28.6	46.1	30.2	49.3	
C	108	140	127	165	165	190	178	216	203	282	229	305	267	267	403	292	419	
ØD	13	13	25	25	38	38	49	49	74	74	100	100	150	150	150	201	201	
ØF	51	51	92	92	105	105	127	127	157	157	216	216	270	324	324	381	381	
ØG	79.4	89	120.7	127	139.7	149.2	152.4	168.3	190.5	200	241.3	270	298.5	362	387.3	431.8	451	
ØH	110	125	150	165	180	190	190	210	230	255	280	320	345	405	445	485	520	
I	2	2	2	2	2	2	2	2	2	2	2	2	2	2	2	2	2	
Torque(Nm)	5	8	12	16	25	35	30	44	70	110	140	180	350	350	550	460	1000	

Note: 1. All dimensions are in mm unless otherwise specified. **2.** As part of our commitment to continuous product development dimensions and specifications are subject to change without notice, for up to date information please contact us or visit our website.

SANKEY

SANKEY SERIES 40

#400 Three Piece Ball Valve

Sankey Series 40 is fire safe resilient-seated ball valve, ideal for use in a wide range of applications.

Sankey series 40, 3 piece ball valve is high performance general purpose ball valve. Designed for in-line maintenance, Sankey resilient seated ball valve offer superior performance at low-cost, and is available in BSP/NPT threaded and weld end connections.

General Features

- Full Compliance to ASME B16.34
- Fire Tested to API-607
- ISO 5211, directing mounting for actuation
- In-line maintenance capability
- M-PTFE seats available
- Versatile Adaptor (End connection)- available in combinations
- Lockable handle
- Body cavity fillers available

SIZE	15MM	20MM	25MM	40MM	50MM
#400 FB					
ØA	13	19	25	38	49
B	60	72	89.5	125	155
C	31.3	40	48.7	75	85
Torque(Nm)	8	9	16	30	40

S.NO.	PART NAME
01	BODY
02	END CONN.
03	BALL
04	STEM
05	SEAT
06	STEM SEAL
07	GLAND
08	GLAND BEARING
09	SPACER
10	STEM THRUST WASHER
11	BODY SEAL
12	STEM O-RING
13	STUD
14	HEX NUT

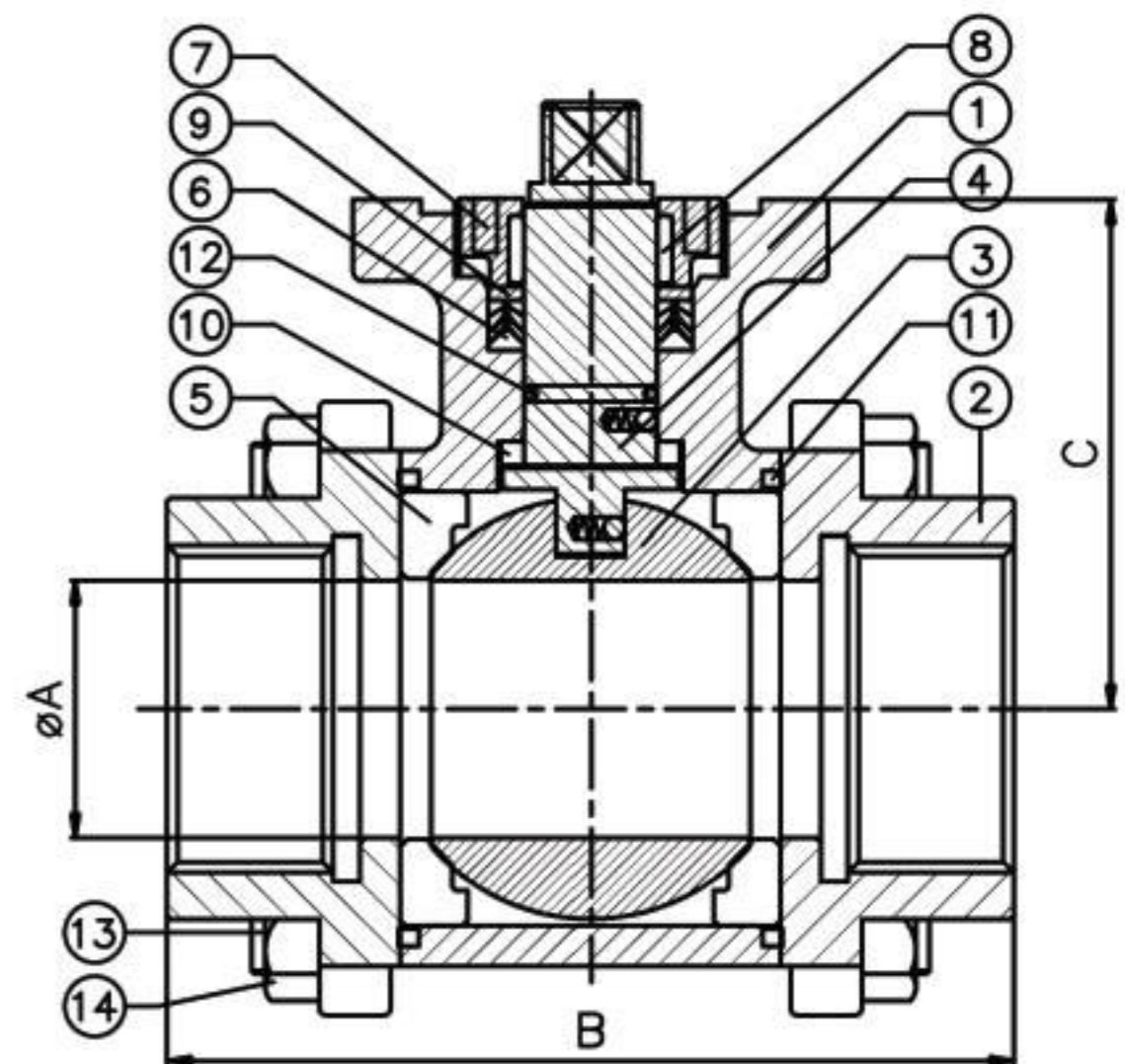

SANKEY SERIES 40L

Sankey Series 40L is a full bore, 3-way L-port Ball valve and is available in BSP /NPT threaded and weld end diverter configuration.

General Features

- Full Compliance to ASME B16.34
- Fire Tested to API-607
- ISO 5211, directing mounting for actuation
- In-line maintenance capability
- Open and closed locking device for positional safety lockout
- Body cavity fillers available

SIZE	15MM	20MM	25MM	40MM	50MM
#400 FB					
ØA	13	19	25	38	49
B	60	72	89.5	125	155
C	31.3	40	48.7	75	85
D	43	50	60	90	108
Torque(Nm)	8	9	16	30	40

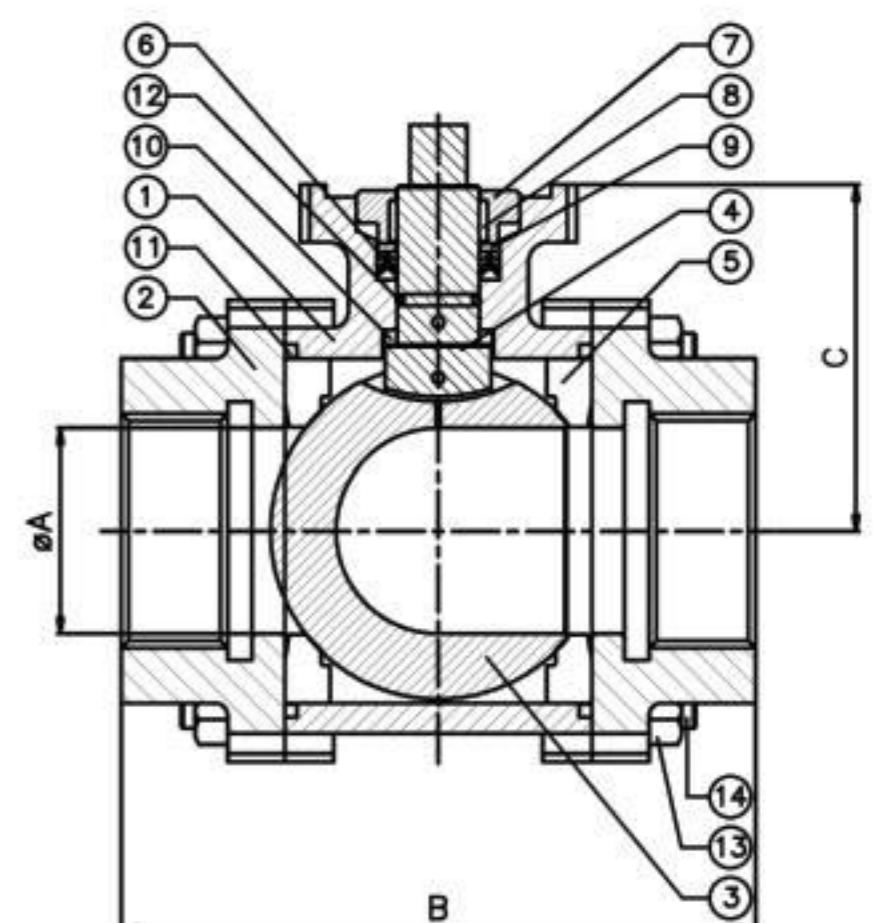
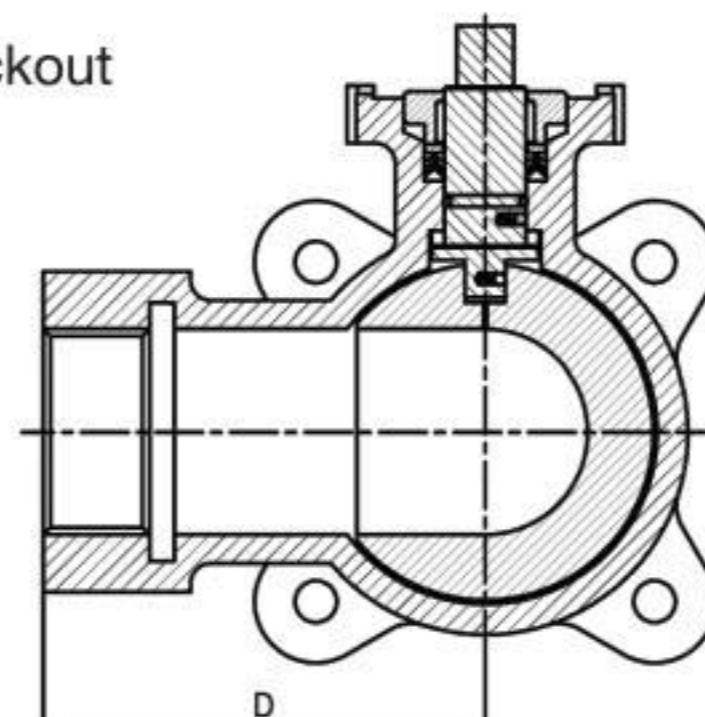

SANKEY SERIES 70/80

#900, #1500 Three Piece Ball Valve

Sankey Floating High Pressure Ball Valves are designed as per API 6D and BS 5351, Fire Safe according to API 607. End connection are RF according to ANSI B16.5, RTJ and BW in a Full Bore and three pieces bolted body type side entry design. Our ball valves are made of casting steel which are radiographed 100% as standard for additional safety. Internals are forged from duplex steel for higher strength. These valves are suitable for pressures up to 280bar. Sankey can provide, as standard, a wide choice of seat materials in order to satisfy the requirements of the oil and gas industry.

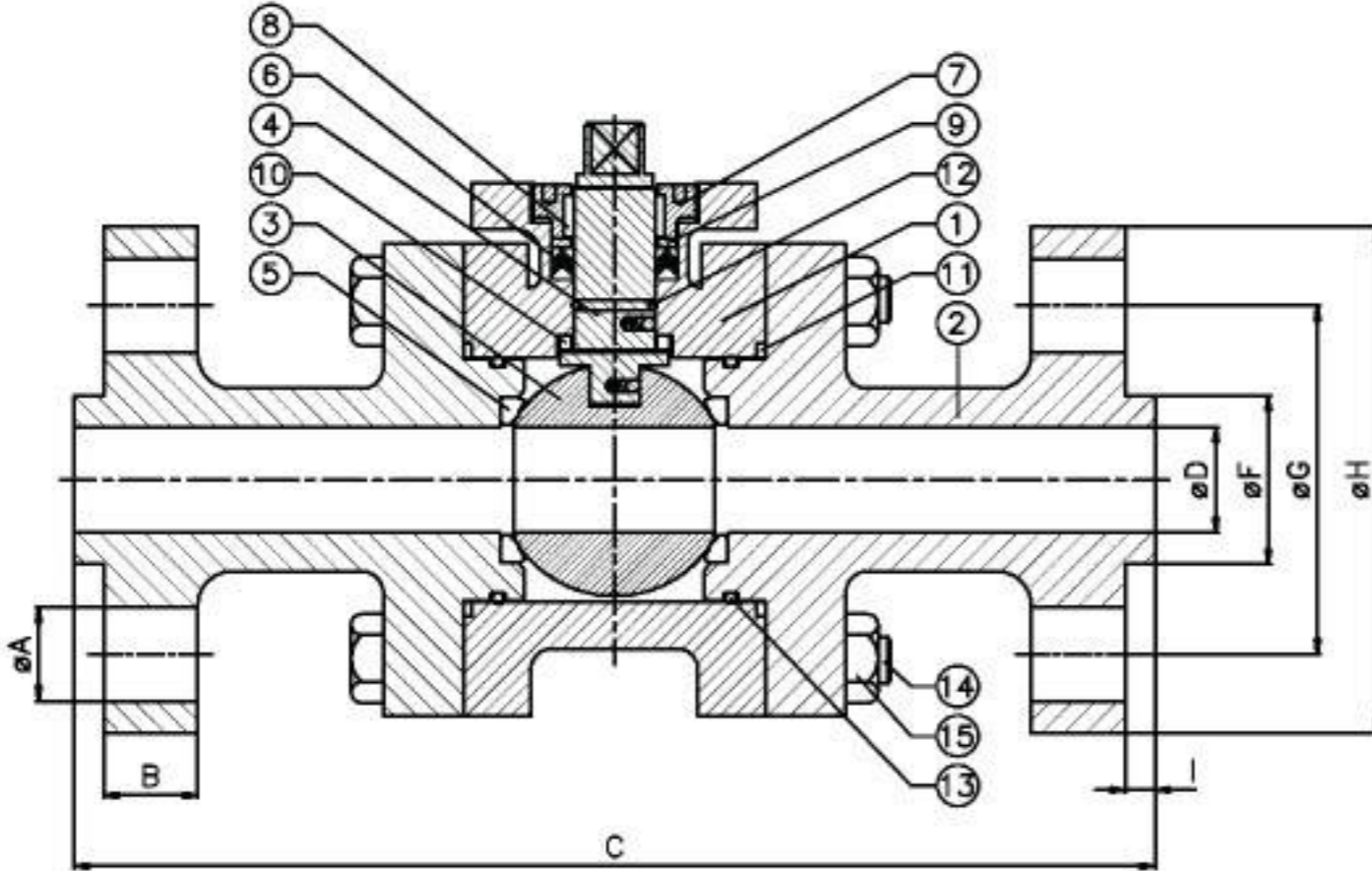

SIZE	15MM	20MM	25MM	40MM	50MM	80MM
	#900 / #1500					#900
ØA x Nos.	22x4	22x4	25.4x4	28.5x4	25.4x8	25.4x8
B	22.3	25.4	28.6	31.8	38.1	38.1
RF	216	229	254	305	368	381
C BWE	216	229	254	305	368	381
RTJ	216	229	254	305	371	384
ØD	13	19	25	38	49	74
ØF	35	43	51	73	92	127
ØG	82.6	88.9	101.6	123.8	165.1	190.5
ØH	120	130	150	180	215	240
I	7	7	7	7	7	7

S.NO.	PART NAME	S.NO.	PART NAME	S.NO.	PART NAME
01	BODY	06	STEM SEAL	11	BODY SEAL
02	END CONN.	07	GLAND	12	STEM O-RING
03	BALL	08	GLAND BEARING	13	END CONN. O-RING
04	STEM	09	SPACER	14	STUD
05	SEAT	10	STEM THRUST WASHER	15	HEXNUT

SANKEY SERIES 90

#2500 Two Piece Ball Valve

Sankey High Pressure Floating Ball Valves are designed as per ASME B16.34 and API-6D, The valve is forged as two piece design and is available in RTJ and BW. These valves are suitable for pressures up to 450 bar.

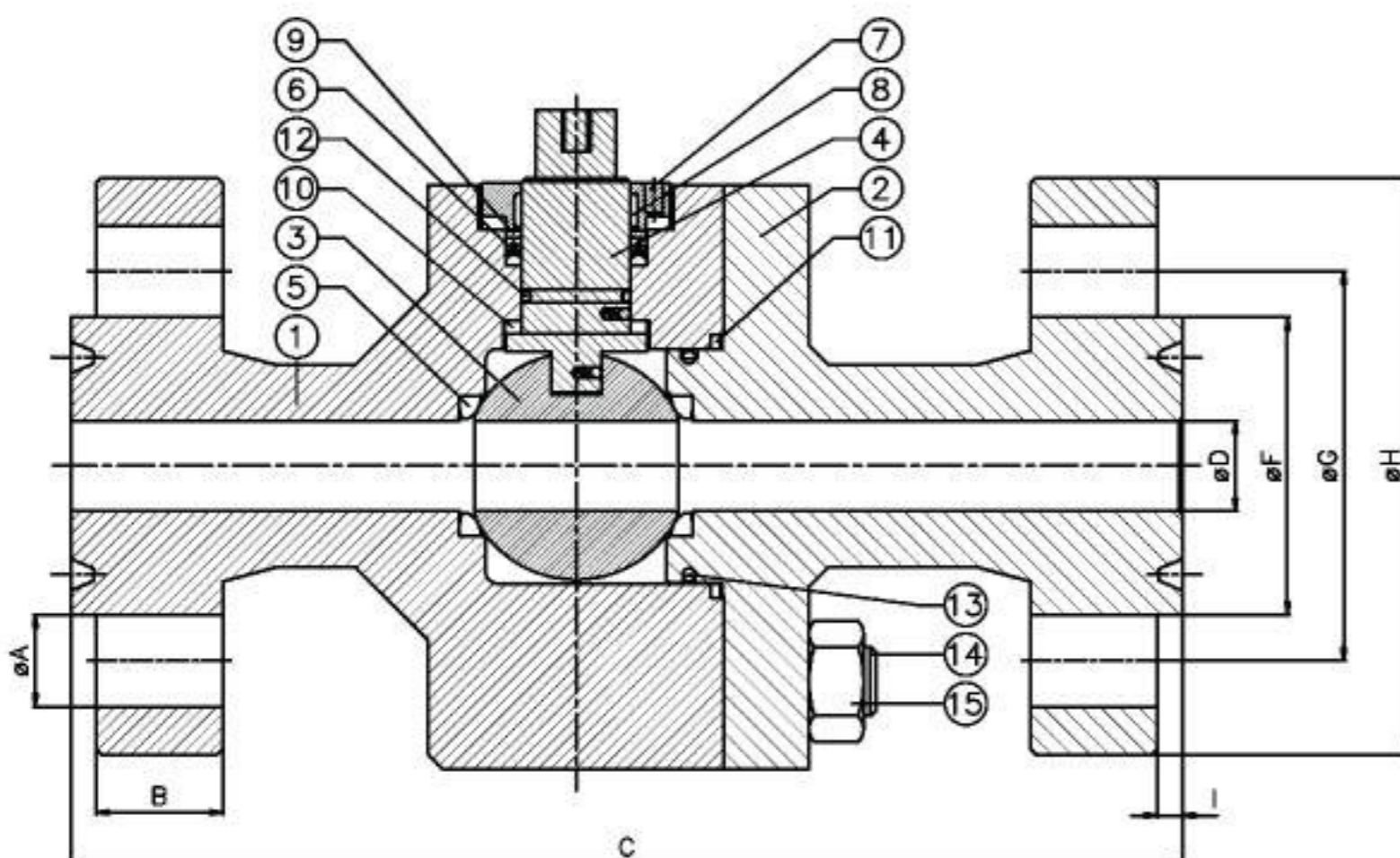

SIZE	15MM	20MM	25MM	40MM	50MM
	#2500 FULL BORE				
ØA x Nos.	22x4	22x4	25.4x4	32x4	28.5x8
B	30.2	31.8	35	44.5	50.9
RF	264	273	308	384	451
C BWE	264	273	308	384	451
RTJ	264	273	308	387	454
ØD	13	19	25	38	42
ØF	35	43	51	73	92
ØG	88.9	95.2	108	146	171.4
ØH	135	140	160	205	235
I	7	7	7	7	7

Note: 1. All dimensions are in mm unless otherwise specified. 2. As part of our commitment to continuous product development dimensions and specifications are subject to change without notice, for up to date information please contact us or visit our website.

SANKEY

SANKEY SERIES WF

Sankey Wafer type ball valves provide all the benefits of flanged ball valves while reducing the cost and weight. The valve can be installed between ASME #150 to ASME #900 flanges by utilizing bolts. The raised face insert interlocks with body to reduce the radial piping stress and protects body seal. It is also available in the 3 way L-port diverter configuration also is design to cater various pressure and temperature range.

General Features

- Mounting Flange according to EN ISO 5211
- Shaft Seal with Chevron Rings/ O rings
- Anti-Blow-out Stem and Antistatic
- Double Seals (Body Seal / Body O-ring)
- Fire Tested to API-607

#150 & #300 Wafer Type Ball Valve



SANKEY SERIES 15C

Sankey cavity filled valves have a unique design in which a PTFE cavity fillers are used to fill the void in the valve cavity between the body, ball and seat. These PTFE cavity reduces the chances of residual particles contaminating multiple use line. They are also used in slurry service and processes that could solidify if left in the closed valve body.

The valves are available in Full Bore in #150 and #300 from 15mm to 200mm.

#150 & #300 Two Piece Cavity Filled Ball Valve

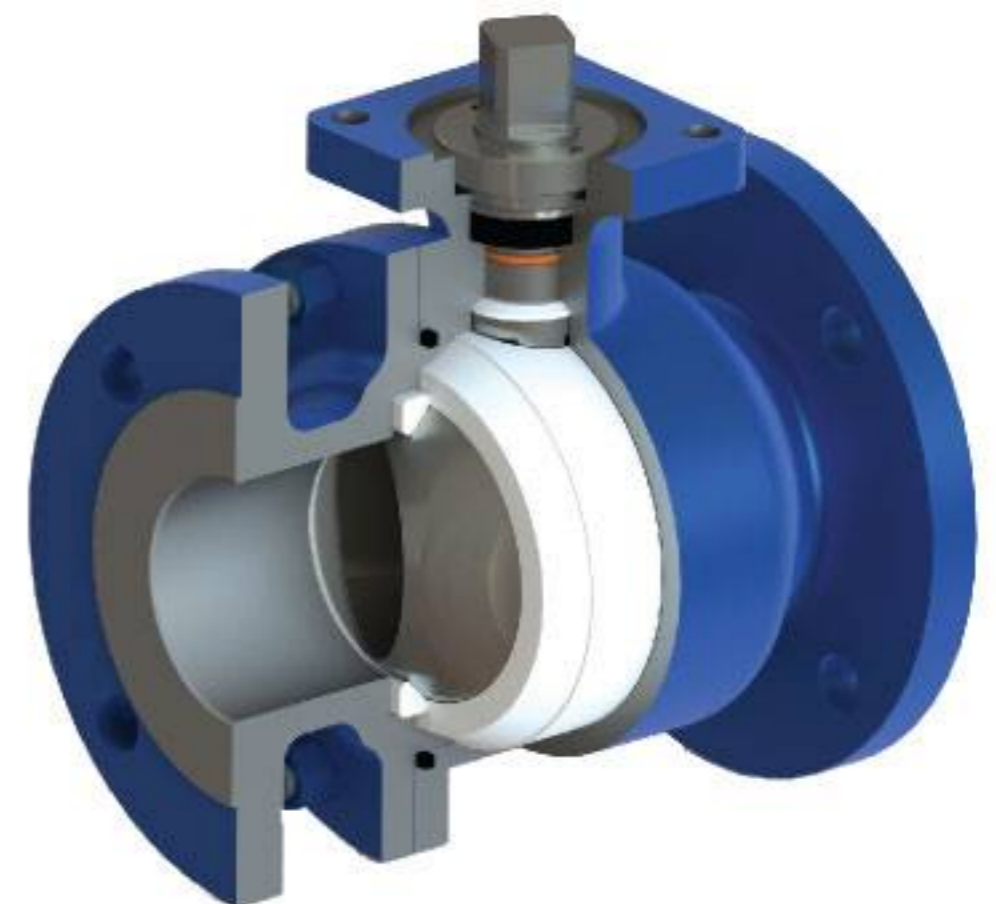

SANKEY SERIES FTB

Sankey Flush Tank Bottom ball valves are designed for general purpose, sanitary process applications. They are available in Full Bore in Class #150 from 25mm to 150mm. The stem is slanted at a particular angle to avoid the handle touching the actuator. With this unique design the valve can be actuated for automation.

General Features

- Max. 180°C, max. 16 bar, Suitable for vacuum service.
- Cavity filler.
- Unique Press/ Push fit seat insert, low torque design.
- Heating Jacket Available on request.
- ISO 5211, directing mounting for actuation.

#150 Flush Tank Bottom Ball Valve



SANKEY METAL SEATED BALL VALVE

Sankey metal seated valves are available with engineered metal seats for today’s demanding process conditions. These metal seated valves are suitable for applications with elevated temperatures or highly abrasive conditions.

The valves are typically provided with hard chrome plated 316SS or electro-less nickel plated ball and hard faced Stellite seats. The valves are manufactured to Class IV shut off but Class VI shutoff can also be provided.

Design Features

- Full bore design ensures actual line capacity flow and reduces the risk of clogging when handling solids and slurries.
- Wall thickness complies with ASME B16.34 and BS 5351.
- Additional stem bearing is provided for some valves to reduce side thrust on seals and prevents stem wobbling.
- Ball and seats lapped for optimum performance and tight shutoff.
- Blow-out proof stem and low emissions seal.
- All valves come with graphite packing and backup seal and are fire safe.

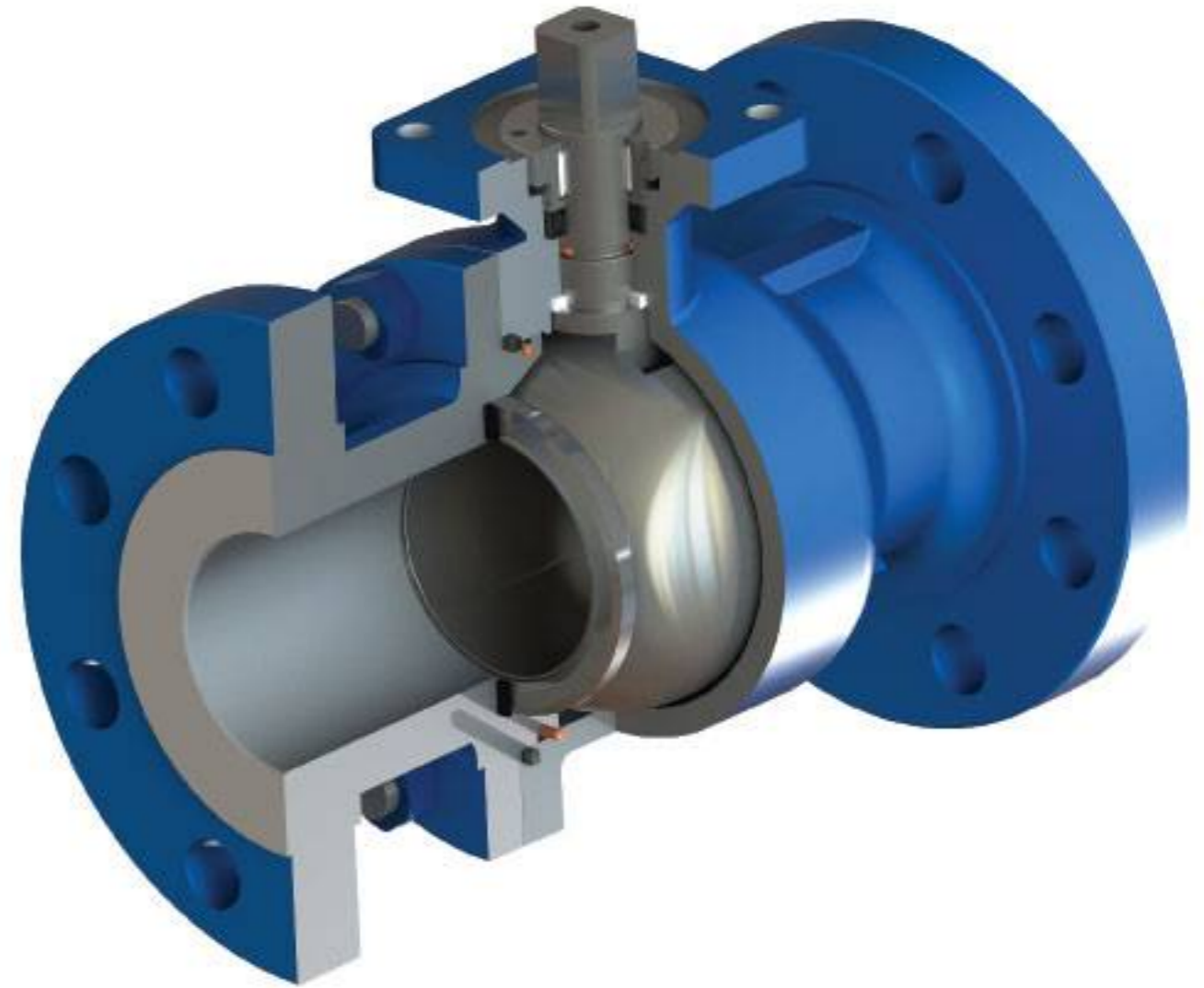

SEAT CONSTRUCTION

STANDARD SEAT CONSTRUCTION

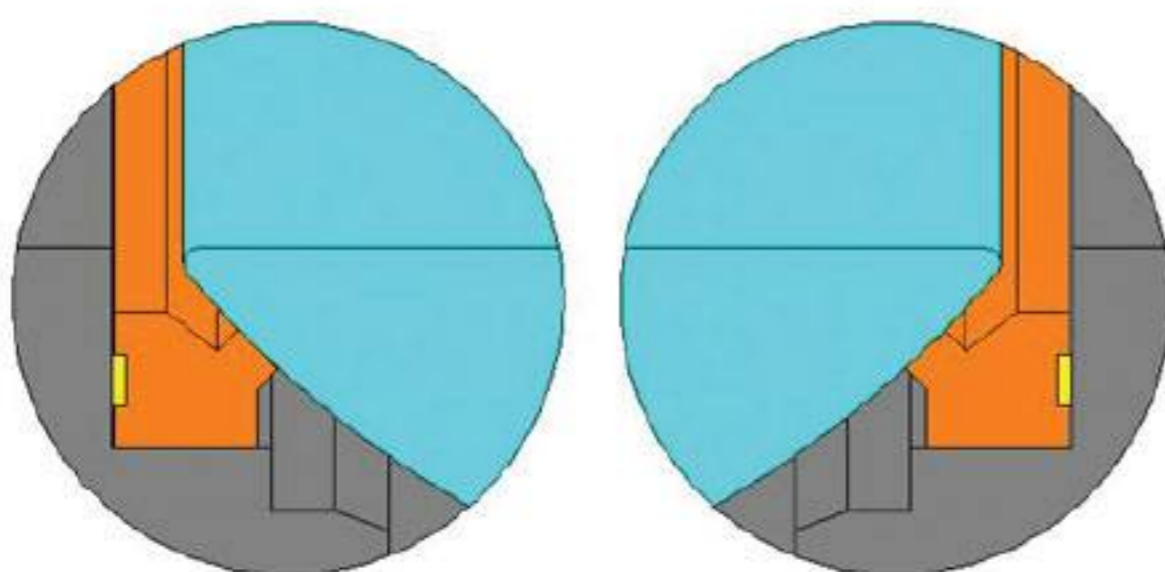

Description	Locked scraper with bi-directional shutoff
Material	SS316 hardfaced with Stellite 6
Seal	Grafoil
Temperature	Upto 743°F (395°C)

HIGH TEMPERATURE SEAT CONSTRUCTION

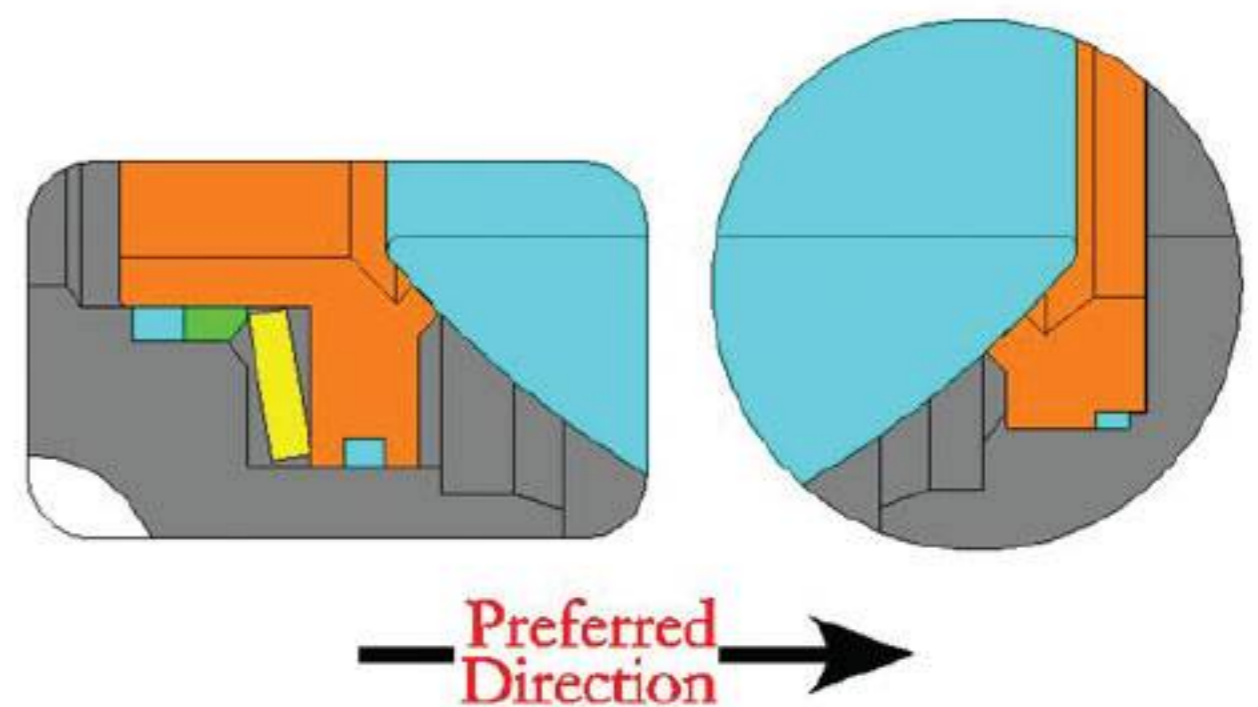

Description	Spring-loaded bi-directional sealing
Material	SS316 hardfaced with Stellite 6
Seal	Grafoil and Inconel load ring
Temperature	Upto 1000°F (538°C)

PRESSURE TEMPERATURE GRAPHS

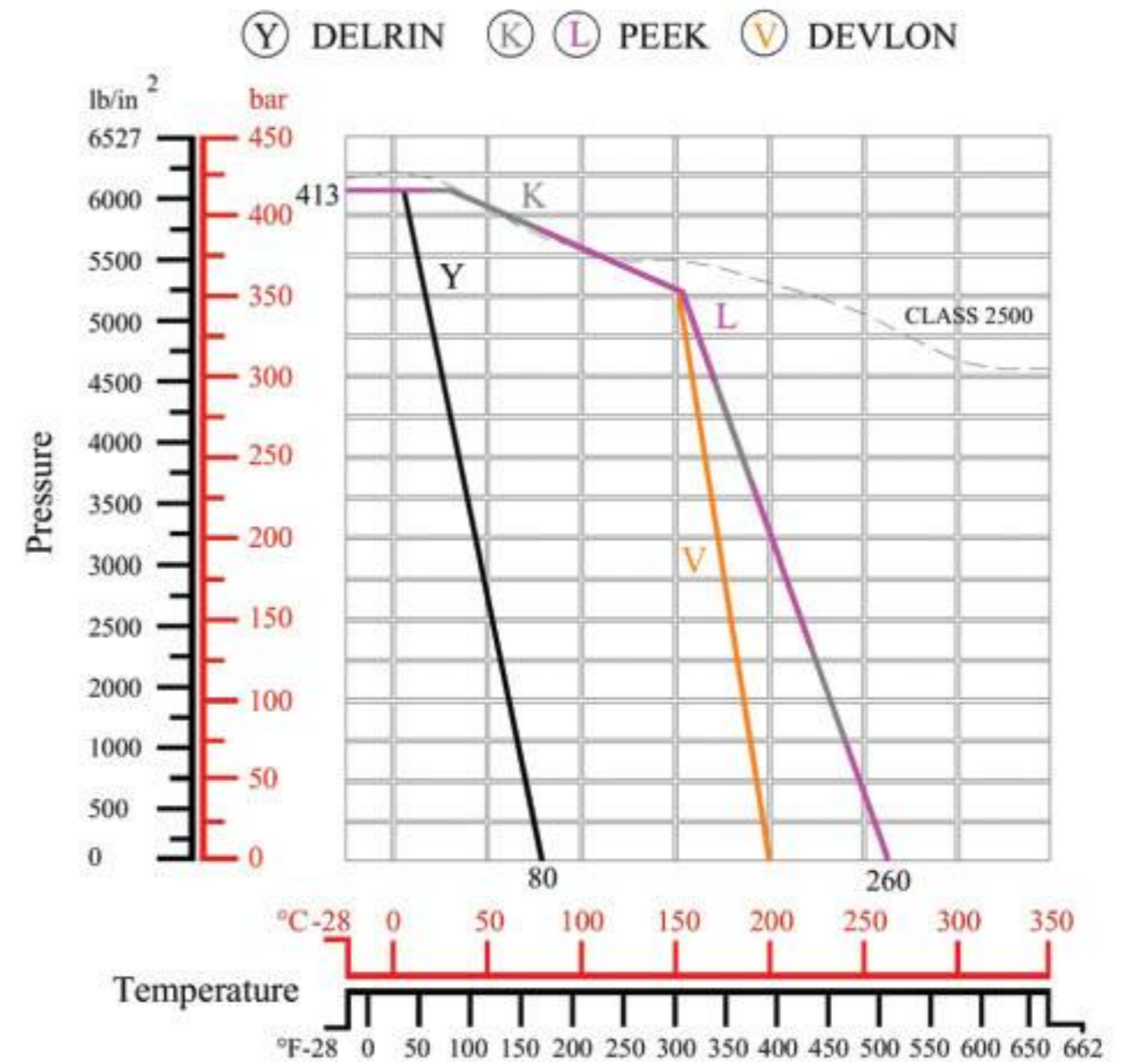
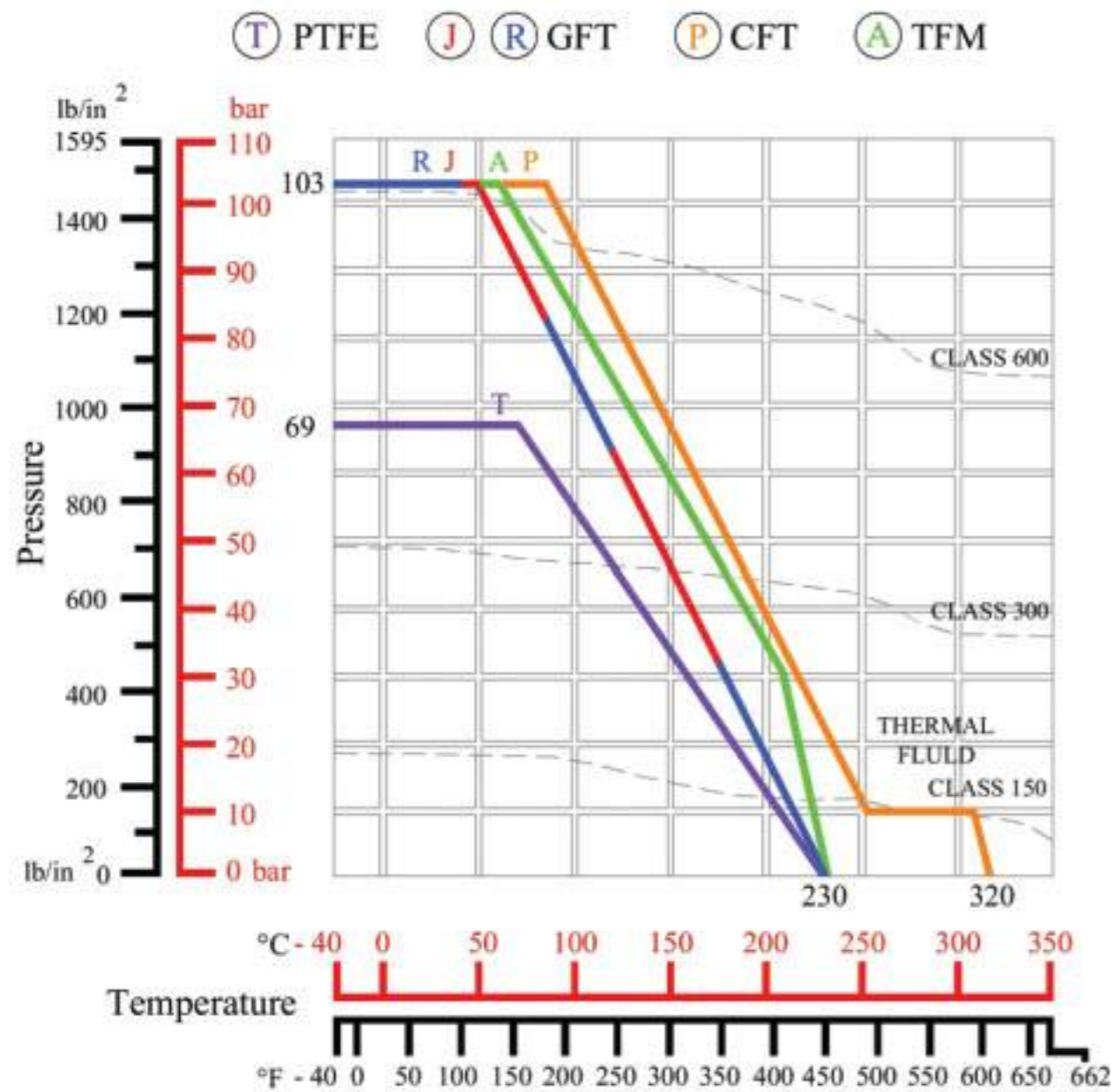

Consult ASME 16.34 for specific material pressure/temperature ratings.

MATERIALS:

T VIRGIN PTFE

Inert to most chemicals, low coefficient of friction, recommended for water, foodstuff and corrosive chemicals. FDA grade.
Colour: White

R 15% GLASS FILLED PTFE

Similar to Virgin PTFE seats but better resistance to wear and deformation under load.
Colour: Gray-White

J 25% GLASS FILLED PTFE

Similar to 15% glass filled PTFE seats but even better resistance to wear and deformation under load.
Colour: Gray-White

P CARBON FILLED PTFE - CFT

Specially for steam and thermal oil, low coefficient of friction, inert to most media.
Colour: Pale Black

A TFM (Modified PTFE)

TFM is a chemically modified PTFE that offers enhanced properties while retaining all the proven advantages of conventional PTFE. FDA grade.
Color: White

Y ACETAL RESIN (DELTRIN)

Suitable for high pressures, good resistance to wear and deformation under load, temperature limit 80°C. **Must not be used in presence of oxygen.**
Colour: Creamy White

L VIRGIN PEEK

Similar to filled PEEK but higher coefficient of friction, suitable for nuclear, Tobacco, clean applications. FDA grade.
Colour: Beige

K CARBON FILLED PEEK

Suitable for elevated temperatures, good resistance under high pressure loads, low coefficient of friction, & many corrosive applications.
Colour: Charcoal Black

V DEVLON

Devlon V-API is a high molecular weight polyamide that is specifically tailored for high temperature/pressure. Applications in the offshore oil & gas sector.
Colour: Yellow

APPLICABLE STANDARDS

API - AMERICAN PETROLEUM INSTITUTE

API 598	Valve Inspection and test
API 607 rev. 5	Specification for fire test for soft seated quarter turn valves
API 608	Metal ball valves, flanged, threaded and welding ends

ASME - AMERICAN SOCIETY OF MECHANICAL ENGINEERS

B16.5	Steel pipe flanges and flanged fittings
B16.10	Face to Face and end to end dimensions of valves
B16.25	Butt welding ends
B16.34	Valves - flanged, threaded and welding ends

CE - CONFORMITÉ EUROPÉENNE OR EUROPEAN CONFORMITY

CE	EC certificate of conformity with EC design examination approval to PED
----	---

BS - BRITISH STANDARD

BS EN ISO 10204	Inspection Documents
BS EN 17292	Steel ball valves for the petroleum, petrochemical and allied industries

ISO - INTERNATIONAL ORGANIZATION FOR STANDARDIZATION

ISO 9001	Quality Management Systems
ISO 5211	Industrial valves - part turn actuator attachment

NACE - NATIONAL ASSOCIATION OF CORROSIVE ENGINEERS

MR0175	Sulphide stress cracking resistant metallic materials for oilfield equipment
MR0103	Sulphide stress cracking resistant metallic materials for petroleum refining

VALVE AND QUARTER TURN AUTOMATION SOLUTIONS

Inventory, assembly, functional testing, validation testing, complete inhouse capability.

Sankey has the most complete in-house custom valve solutions provider in the India. Our Valve Automation Center gives us in-house capabilities that allow us to design, fabricate, build and test all of our automated valve assemblies here in our Pune facility.

Working with our valve or your valve and actuator principles, we maintain a high level of quality and design integrity. Actuation products include electric actuators, pneumatic and hydraulic actuators, and control accessories.



Same day shipment of Sankey valves actuation packages!

OUR CAPABILITIES

- Quarter-turn actuation / Multi-turn/ Linear actuation.
- **Critical 24-hour** and same-day shipments as required.
- Positioners, Digital positioners, Position switches and Feedback transmitters, Filter/regulators, Quick exhaust pilots, Flow boosters, Solenoid piloted valves, Lock-up valves, Volume tank fail safe systems, speed control systems and Manual override gear box systems.
- Complete **In-house machine shop, weld shop** and **painting** for custom fabrication.
- **Actuator product inventory.**
- Hydro Seat leak and heat testing.
- Field service support by trained and experienced Sankey technicians.

INSTOCK

- Pneumatic and Electric
- Control accessories and mounting hardware
- ESD packages

SANKEY

VALVE . ACTUATION . LSB

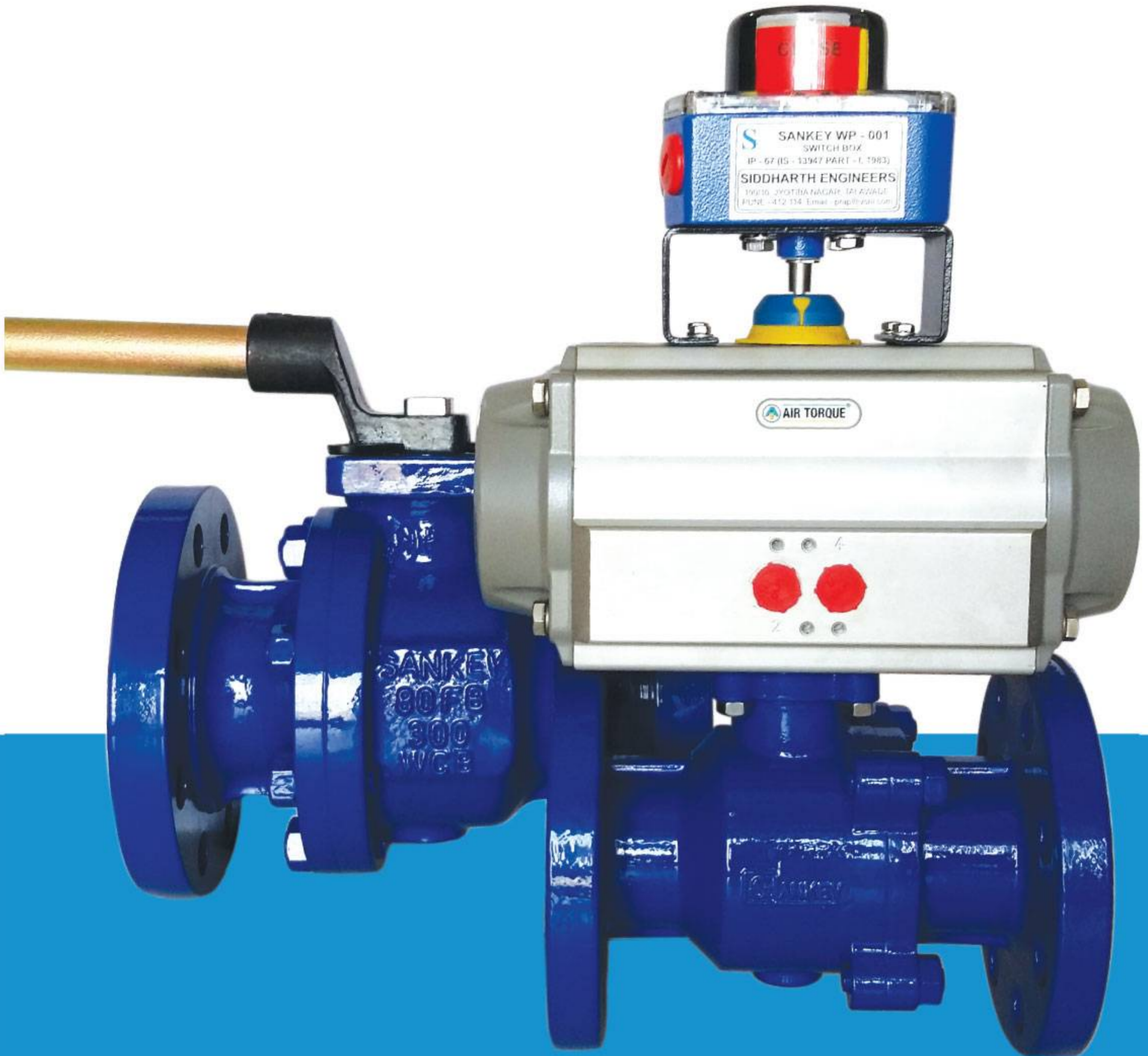

Distributor



SANKEY CONTROLS PVT. LTD.

reliability in your process...

Gat No.199, Plot No.10, Jyotibanagar, Talawade,
Pune - 412114. Maharashtra, India.

Ph : +91 9922957922 / 23 / 27 / 31

Fax : +91 20 27651512

E-mail : sales@siddharthengineers.com

Website : www.siddharthengineers.com,
www.siddharthengineers.net

